

User's Reference Card

StimRouter Electrode/External Pulse Transmitter (EPT) Set-Up

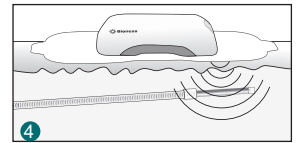

1. After the EPT is charged, snap the EPT onto the StimRouter Electrode.
2. Remove the electrode liner and store it in the StimRouter Electrode Carrying Case.
3. Grasp the edges of the EPT attached to the StimRouter Electrode so the gel pads face down.
4. Adhere the end of the StimRouter Electrode, that has the EPT charging port, directly over the receiver end of the lead. **Note:** The center of the gel pad should be above the receiver end of the lead.

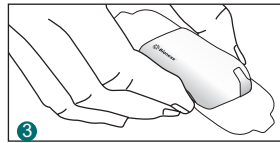
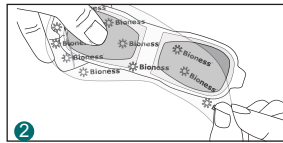
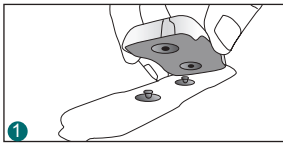

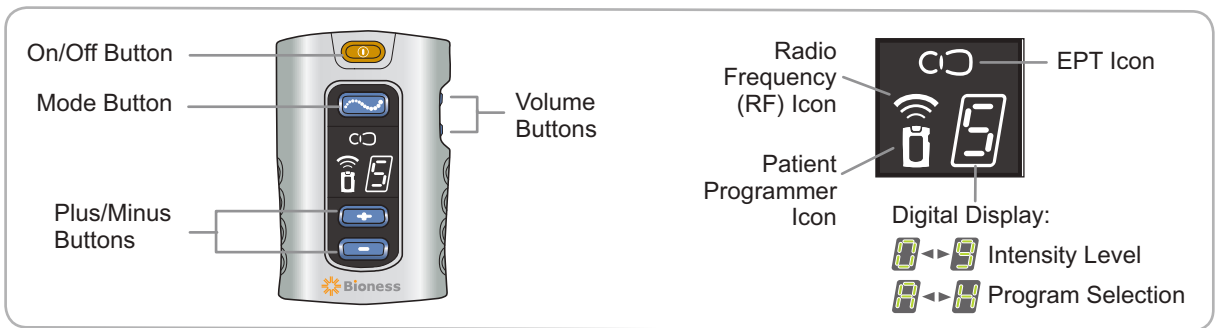
Patient Programmer Operating Instructions



Turning the System On/Off: Press the on/off button once and release. The button flashes green  indicating the system is on and is in standby mode. Press the on/off button once and release to turn off the system, the button will stop flashing.

Selecting a Program: Press and hold the mode button for at least three seconds until it glows yellow . Press the plus  or minus  button to change the active program (shown as A-H in the digital display). Press the mode button again to exit program mode.

Turning Stimulation On/Off: From standby mode, press the mode button briefly until it flashes yellow  indicating that stimulation is on. Press the mode button briefly or the on/off button to turn the stimulation off.







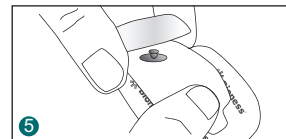
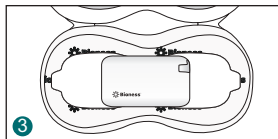
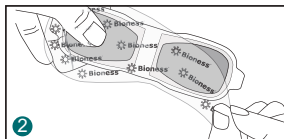
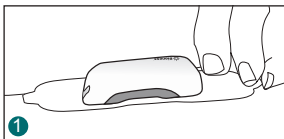

Change Stimulation Intensity: Press the plus  or minus  button in stimulation or standby mode to change the active stimulation level (shown as 0-9 in the digital display).

StimRouter Electrode and EPT Removal

1. Turn stimulation off. Grasp the tab on the StimRouter Electrode and gently pull the electrode away from the skin. **Note:** Do not grasp the gel pads on the back of the electrode.
2. Attach the StimRouter electrode liner to the gel pads.
3. Store the StimRouter electrode and EPT in the StimRouter Electrode Carrying Case.
4. Remove the EPT from the StimRouter Electrode when the gel pads appear worn, can no longer adhere to the skin, or after a maximum of four days of use.
5. Make sure the StimRouter Electrode liner is on. Hold the EPT and gently pull the StimRouter Electrode away from the EPT to unsnap it.



Troubleshooting

	EPT Icon Flashes Yellow	EPT Battery Charge Level is Low
	EPT Icon Glows Red and "E" appears in Digital Display	EPT Malfunction
	EPT Icon Flashes Red and "E" appears in Digital Display	EPT Temperature Error
	EPT Icon Flashes Red and Intensity Level Flashes in Digital Display	Faulty Electrode Contact
	RF Icon Flashes Red	Radio Communication Failure or EPT Battery Failure
	RF Icon Glows Red and "E" appears in Digital Display	Registration Failure
	Patient Programmer Icon Flashes Yellow	Patient Programmer Battery Charge Level is Low
	Patient Programmer Icon Glows Red and "E" appears in Digital Display	Patient Programmer Malfunction or Charging Error (while charging)

Rx Only

©2017

602-00632-001 Rev. C
11/2017



See User's
Guide

Bioness Inc.

25103 Rye Canyon Loop
Valencia, CA 91355 USA
Telephone: 800.211.9136 or 661.362.4850
Website: www.bioness.com